

REGIO

dry siphon anti-odour transparent and removable with aesthetic lid

- cod. 11126322B - cod. SCD3E0008

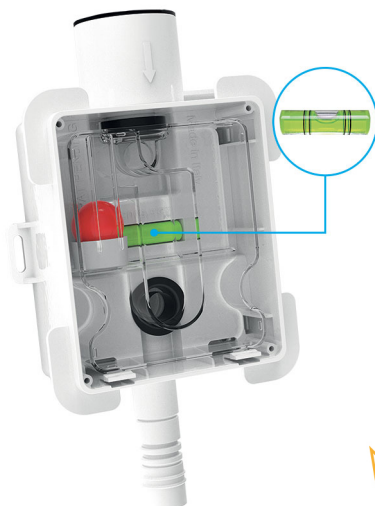

 REGIO

TECHNICAL SPECIFICATIONS:

- Flow rate 60 l/h
- Pipe inlet dimensions from \varnothing 16 to \varnothing 28
- Drain pipe dimensions \varnothing 21
- Top inlet is equipped with gasket
- Built-in spirit level
- Material: siphon in polystyrene, siphon box in polypropylene
- External ridge for installation flush with unfinished wall
- Suitable for wall installation or vertical sub-track installation
- Max temperature of the waste water 60°C

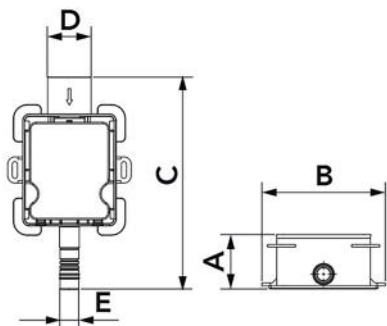

DIMENSIONS

CODE	A [mm]	B [mm]	C [mm]	D [mm]	E [mm]
11126322B	55	120	230	46,5	21
SCD3E0008	--				

TUBE OUTLET COUPLER COMPATIBLE WITH:

- Rigid condensate drain pipe TCR-21 with MG coupling sleeve
- Condensate drain pipe Ø 40 - 36 - 32 - 28 with MG adapter sleeve
- Condensate drain pipe Ø 20 double cladding sleeves Ø 18/20
- Condensate drain pipe reinforced by under-track Ø 20 single cladding with o-ring
- Blue condensate drain pipe reinforced by under-track Ø 20 single cladding - sleeves Ø 18/20

PACK COMPLETE WITH

- Siphon box with built-in level
- Protective cover for the construction phase
- Rubber seal for piping inlet
- Transparent siphon
- Aesthetic finish lid

ITEMS

CODE	DESCRIPTION
11126322B	CLEAR REMOVABLE ODOUR-STOP WATERLESS TRAP "REGIO" WITH ATTRACTIVE COVER
SCD3E0008	AESTETIC COVER FOR ODOUR-STOP TRAP "REGIO"

All rights relating to this publication are the exclusive property of Tecnosystemi SpA.

Tecnosystemi SpA reserves the right to make changes at any time and without notice, for technical or commercial needs.