

# DATASHEET

rev. 02 - 6/10/2022

Industrial centrifugal air curtain large flow rates with front extraction

12300042 - AAC400001



## TECHNICAL SPECIFICATIONS:

- Front air intake
- The unit must be installed horizontally
- Suitable for doors of large dimensions
- Maximum installation height 5 m
- Ideal for industries and warehouses

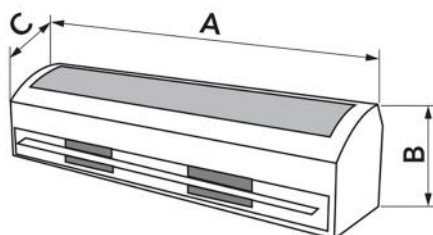

## DIMENSIONS

CODE	MODEL	A [mm]	B [mm]	C [mm]	FOR DOORS WITH DIMENSIONS [mm]
12300042	1000	1000	287	297	Hmin.3000 Hmax.5000
AAC400001	1500	1500	287	297	Hmin 3000 Hmax 5000

## TECHNICAL DATA

CODE	SUPPLY VOLTAGE [V]	FREQUENCY [Hz]	POWER CONSUMPTION [W]	AIR SPEED AT INLET [m/s]	AIR FLOW RATE [m³/h]	SOUND POWER LEVEL [DB(A)]	WEIGHT [kg]
12300042	380 ac	50	1100	28	3709	64	32,7
AAC400001	380 ac	50	1850	28	5563	68	52

## WIRING INSTALLATION DIAGRAM

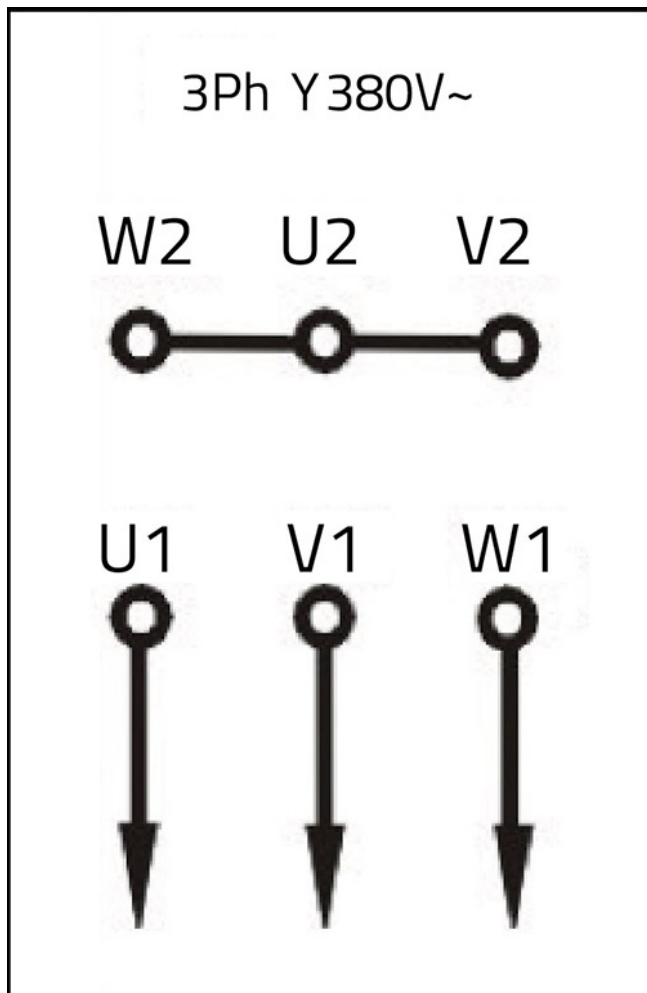

### ATTENTION!

The air curtain must be installed by qualified personnel in accordance with Standard IEC 64.8 (electrical connection).

### ATTENTION!

Before commissioning the air curtain, make sure that it is not connected to the electrical power supply and wear protective rubber gloves.

## INSTALLATION AND START-UP

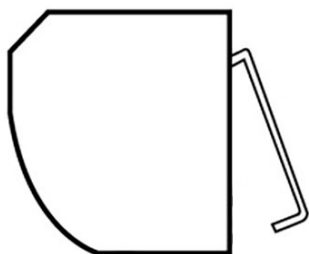

Unscrew the mounting plate and remove it.

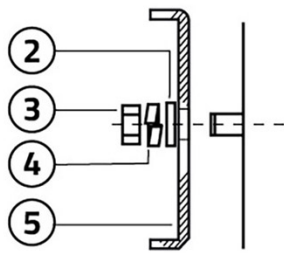

Drill a hole as shown in the instructions and insert the bolt into it, securing it with cement.

- [2] Washer
- [3] Nut
- [4] Elastic washer
- [5] Assembly plate

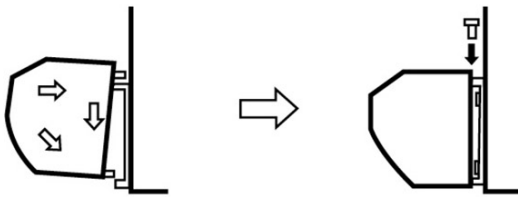

Install the air curtain on the mounting plate, making sure that it is in the safety position and tighten it with the appropriate screws.

## GENERAL WARNINGS

- For safety reasons, the apparatus has to be installed on a solid wall in such a way as to avoid vibration and excessive noise
- Air curtains are designed for indoor use.
- Choose the model according to the installation height: if it is too high, it may adversely affect the operating distance and reduce the effectiveness of the apparatus
- If the door is wider than the air curtain, several units may be installed side-by-side, leaving a space of 20 to 40 mm between one apparatus and the other
- The assembly plate shall be installed on a single, uniform wall
- There has to be a distance of at least 50 mm between the unit and the ceiling
- The unit must be installed horizontally
- The installation height shall not be less than 3 m above the ground
- The connection must be preceded by a three-pole switch with a minimum opening of at least 3 mm between the contacts

## ITEMS

CODE	DESCRIPTION
12300042	"ARIA 1 POTENZA" HIGH-CAPACITY INDUSTRIAL AIR CURTAINS 100
AAC400001	HIGH PERFORMING AIR CURTAINS WITH FRONT AIR INTAKE "ARIA 1 POTENZA" 1500