

# FVP-250

medium strength profile

- cod. FVD100021 - cod. FVD100038 - cod. FVD100022
- cod. FVD100039 - cod. FVD100030



## TECHNICAL SPECIFICATIONS:

- Material: EN AW 6060
- Profile weight: 0.6 kg/m
- Section: 236 mm<sup>2</sup>
- Modulus of elasticity: 66000 N/mm<sup>2</sup>
- Inertia torque Ix: 24469 mm<sup>4</sup>, Iy: 45213 mm<sup>4</sup>
- Inertia torque Wx: 1529 mm<sup>3</sup>, Wy: 2380 mm<sup>3</sup>

## TECHNICAL DRAWING:

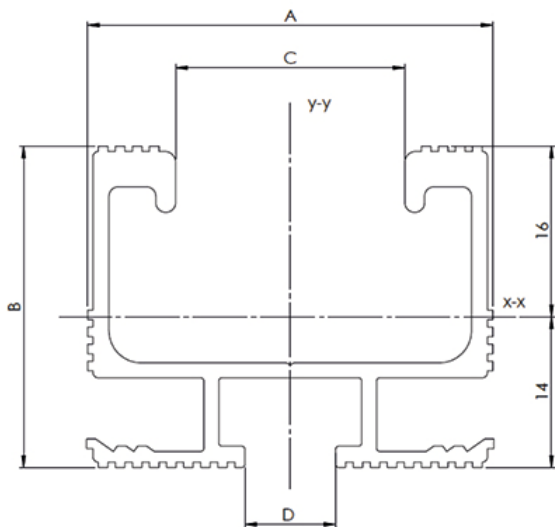

## FULL SIZED:

CODE	LENGTH [mm]	A [mm]	B [mm]	C [mm]	D [mm]
FVD100021	3300	38	30	21,5	8,5
FVD100038	3600	38	30	21,5	8,5
FVD100022	4400	38	30	21,5	8,5
FVD100039	4700	38	30	21,5	8,5
FVD100030	6600	38	30	21,5	8,5

## ITEMS

CODE	DESCRIPTION
FVD100021	PROFILE FVP-250/3.3
FVD100038	PROFILE FVP-250/3.6
FVD100022	PROFILE FVP-250/4.4
FVD100039	PROFILE FVP-250/4.7
FVD100030	PROFILE FVP-250/6.6

All rights relating to this publication are the exclusive property of Tecnosystemi SpA.

Tecnosystemi SpA reserves the right to make changes at any time and without notice, for technical or commercial needs.